



Masefield Way

Kingsley, Northampton

oriordanbond
SALES & LETTINGS



GROUND FLOOR
569 sq.ft. (52.8 sq.m.) approx.

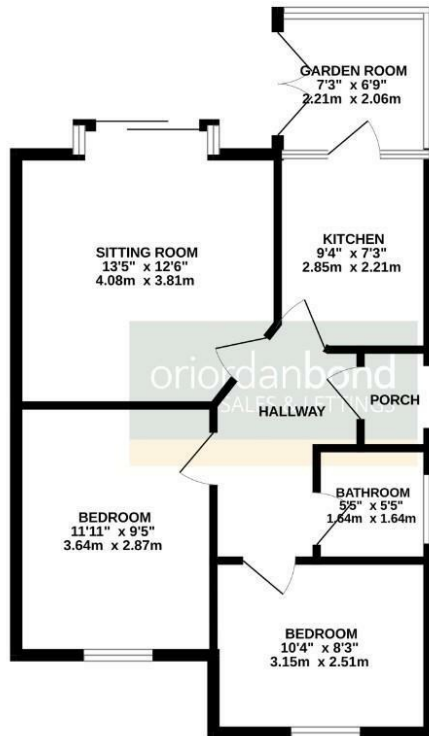

TOTAL FLOOR AREA: 630sq.ft. (58.5 sq.m.) approx.
Whilst every attempt has been made to ensure the accuracy of the floorplan contained here, measurements of doors, windows, rooms and any other items are approximate and no responsibility is taken for any error, omission or misstatement. This plan is for illustrative purposes only and should be used as such by any prospective purchaser. The services, systems and appliances shown have not been tested and no guarantee as to their operability or efficiency can be given.
Made with Hozonix ©2025

Masefield Way

Kingsley
NN2 7JT

OFFERS OVER £225,000

O'Riordan Bond is delighted to offer to the market this beautifully presented two bedroom semi-detached bungalow, which has been thoughtfully improved by the current owners. Offered with no onward chain, the property is located near to many local amenities.

The accommodation comprises porch, entrance hall, sitting room with bay window, re-fitted kitchen, garden room, two double bedrooms and a modern shower room. Externally, the property enjoys a landscaped frontage laid mainly to lawn with block paved driveway providing ample off road parking. To the rear is a generous private garden laid mainly to lawn with patio area and enclosed by hedgerow. Further benefits include uPVC double glazing and gas radiator heating serviced via a newly installed combination boiler. (A/630/M)

Additional information

- Council Tax Band: B
- Energy Efficiency Rating: D

Viewing

Viewing strictly by appointment – details below

Disclaimer

O'Riordan Bond Estate Agents Limited has not tested apparatus, equipment, fittings or services and so cannot verify they are in working order. The buyer is advised to obtain verification from their solicitor or surveyor.

O'Riordan Bond Abington Sales
01604 639007

abington@oriordanbond.co.uk

